

**BAD COPY**

OCT 3-1953

I HEREBY CERTIFY THAT THIS IS A TRUE AND ACCURATE SURVEY OF THE SUBDIVIDED PROPERTY AS SHOWN HEREON.

FINAL PLAN APPROVED  
GREENVILLE CITY PLANNING AND ZONING COMMISSION

A PORTION OF THE  
J. R. JENKINSON ESTATE  
PLAT SHOWING SUBDIVIDED PORTION & PROPOSED STREET  
LAYOUT OF

**KNOLLWOOD**  
A SUBDIVISION LOCATED IN THE  
CITY OF GREENVILLE, S.C.

PICKELL & PICKELL ENGINEERS GREENVILLE, S.C.

SCALE: 1" = 100'

DATE: MAY 1953

NOTE: IRON PIPE MARKERS AT  
LOT CORNERS.

OCT 8-1953

22127

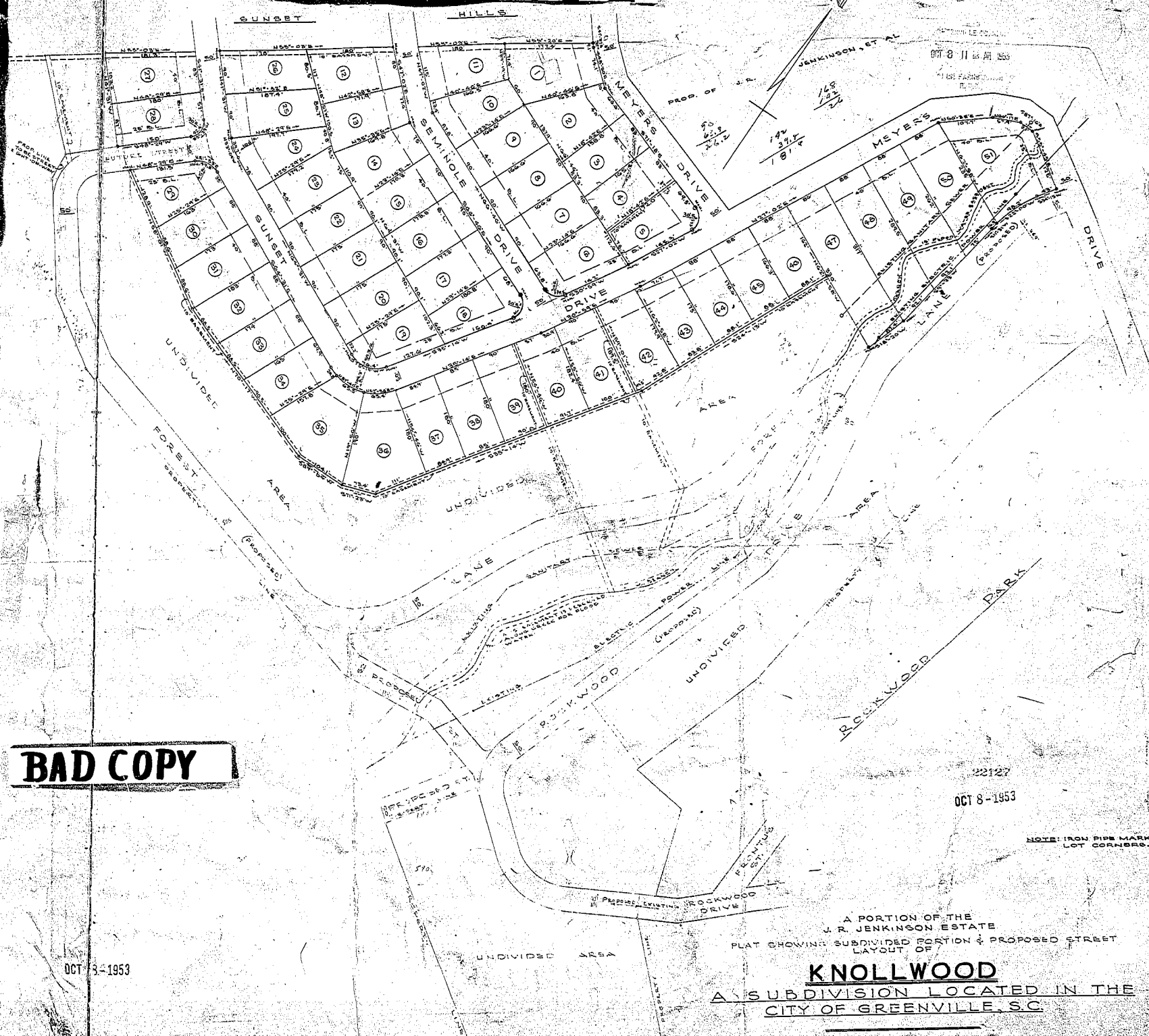

RECORDED IN THE OFFICE OF THE CLERK OF THE DISTRICT COURT OF GREENVILLE COUNTY, S.C. IN BOOK 11 PAGE 118  
OCT 8 11 AM 1953  
PICKELL & PICKELL ENGINEERS GREENVILLE, S.C.